

AREA PLAN

FAIRFIELD TRADE PARK

Villiers Road, KINGSTON UPON THAMES, KT1

Ground & First Floors

Gross External Area

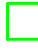
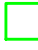
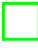
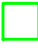
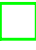
	GEA - Units 1&2	2283.0 sq m	24574 sq ft
	GEA - Unit 3	1161.8 sq m	12506 sq ft
	GEA - Unit 4	1300.7 sq m	14001 sq ft
	GEA - Unit 5	1206.1 sq m	12982 sq ft
	GEA - Units 6	1226.6 sq m	13203 sq ft

TOTAL GEA: 7178.2 sq m 77266 sq ft

The following has been EXCLUDED from the TOTAL GEA:

Canopy 155.1 sq m 1669 sq ft

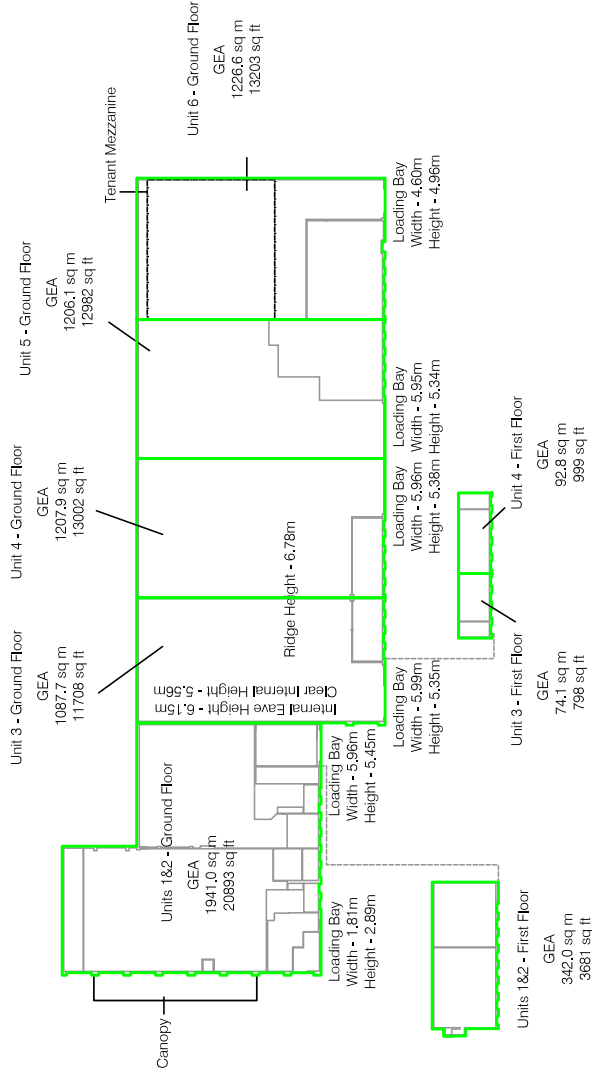

Notes:

 Floor to Ceiling Height (Metres)

A dashed line denotes assumed - Inaccessible due to fit out.

This drawing indicates the extent of the areas quoted.

produced to an accuracy commensurate with standard

presentation scales. It is held in a scaled digital CAD format.

Dwg No. LF3808-GEA-AG

Issue B

November 2021

Scaled for presentation - 1:1000 @ A3



info@laneandfrankham.com / +44(0)20 3714 7063 / www.laneandfrankham.com